

**Petroleum for the Inland (Retail) Fuel Market
LN 53/2010
&
SL 545.22**

**Flammable and non- flammable water polluting liquids storage tanks
On Site Report and Risk Analysis Matrix**

Report Reference Number: Wasteserv Malta SAWTP

1	Details of the Authorised Person / Company Wasteserv Name and Address Eko Centre Triq Latmija, Marsascula ID Card No.: Phone Contact: Mobile Contact: Company MFSA Number: Inspection Date:						Installation Address: Wasteserv Malta SAWTP The Director : 18.01.2019										
	2		1		Serial Number: 11569		Max. working cap. lts		3000 ltrs		Fuel grade Diesel		EN 590				
		Above /underground		Above		Inside/ outside		Outside, with dedicated cover		Tank material		All Steel		Warning notice		Installed	
		Tank ext. protect coat/ material				Paint		Tanks mfg/ last tested									
		Tank Construction: single wall or double wall.				Single wall		Use of Fuel: Tank 1: Dispenser for internal vehicles									
		Construction Standard of Tanks				EN 12258-2 EN 13160 leakage monitoring installed				Installation date:				2017			
		Portable or fixed installation:				Fixed Installation				Qty and frequency of delivery's				Approx. 1000 ltrs /week.			

3. Above ground storage protected from:				7. Fill points:			
a	Vehicle impact		No	a	Presence of spillage containment		Yes
b	Fire threat		None.	b	Safety for subsequent spillage ignition		Yes
c	Accumulation of flammable vapour		Installed outdoors	c	Ventilation to reduce flammable vapor concentration.		Installed outdoors
4. Vents to allow air in & pressure release:				8. Tanker fill points location:			
a	Located within site		Yes	a	Not in risk of collision with moving vehicles		Yes
b	Vent Height > Max liq. level & H > equal 4 m above ground		Yes	b	Not in line of slip of access roads		Internal roads being used
c	In non-emission control systems 5m vent height		Not applicable	c	Not with 4m of public through fare/ boundary		Yes
d	Vent discharge point > 3m from windows or openings		Yes	d	If parallel imperforate concrete wall 2m high, the 4m distance is measured from either side of fill point to boundary round wall.		Not applicable
e	Locate > 2m from boundary(non-emission control 3m		Installed in open area	e	If residential, hospital, school incr. dist 12m		Not applicable

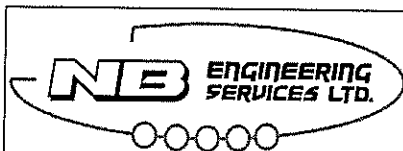

Petroleum for the Inland (Retail) Fuel Market
LN 53/2010
&
SL 545.22

Flammable and non- flammable water polluting liquids storage tanks
On Site Report and Risk Analysis Matrix

Report Reference Number: Wasteserv Malta SAWTP

f	Boundary 2m high & imperforated (non-emission controls 3m), location close to boundary permissible.	Not applicable	9. Underground storage: Not applicable		
g	Powered air intake & heating systems, to assess	Not applicable	Clear from drains, tunnels & foundations	Not applicable	
h	Vent pipes seen from fill point./ check valve installed	Yes			
5. Dispensers: Not Applicable			Easy removal	Yes	
a	Location > 3m from occupied building on site or boundary	Yes, installed on board	10. Road Tanker delivery stands: Fuel delivered to site by barrels, not road tankers		
b	Location > 4m from openings in buildings	Yes	a	Greater than 15m long, 5m wide	Yes
c	Location > 9m from domestic premises/vulnerable persons	Yes	b	Clear forward direction exit route	Yes
d	Location open air	Yes	c	Leveled, include largest likely spill drainage	Yes
6. Bunds:			d	Emer. Tel line, fire fight equip., sand bucket & 2x9kg dry powder fire extinguisher at hand	To install
a	Bund size L x B x H	Tank supplied with its own bund from EU supplier	11. High Risk Location: Low		
b	Total bund volume & material 110% of the tank volume	Confirmed	a	Spring, well, borehole (50mtrs)	No
c	Bund impermeable	Supplied by EU mfg.	b	Water course (10mtrs)	No
d	Bund drainage system	Bund is not connected or near drain. Totally isolated.	c	Open drains	No
e	Leak detection installed	Installed	d	Any other hazardous materials stored in vicinity.	None
f	Auxiliary tanks	Not applicable			

12. Risk Assessment Matrix -Recommendation

No.	Situation	Classification N/A – 0 Low – 1 Medium – 2 High - 3	Corrective Action	Target Date	Implemented Date
12.1	None				
12.2					
12.3					

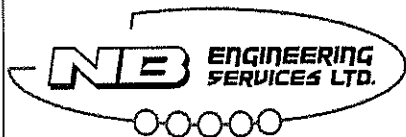

Petroleum for the Inland (Retail) Fuel Market

LN 53/2010

&

SL 545.22

Flammable and non- flammable water polluting liquids storage tanks
On Site Report and Risk Analysis Matrix

Report Reference Number: Wasteserv Malta SAWTP

13. Sketch: See attached sketch

Photos: See separate sheet.

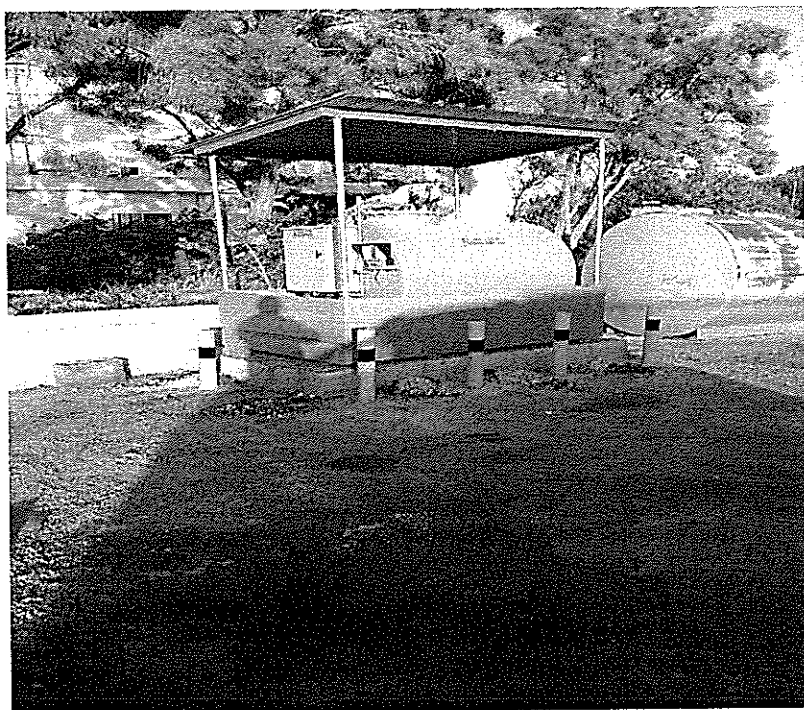

A handwritten signature, possibly 'J.B.', written in a cursive style.

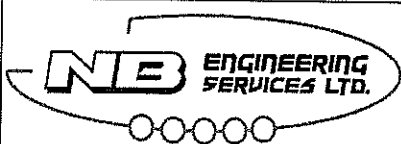

Petroleum for the Inland (Retail) Fuel Market

LN 53/2010

&

SL 545.22

Flammable and non- flammable water polluting liquids storage tanks
On Site Report and Risk Analysis Matrix

Report Reference Number: Wasteserv Malta SAWTP

14. Tank Certificates /

Commissioned and certified compliant with EU standards

A handwritten signature in black ink, located in the bottom right corner of the page. The signature is stylized and appears to be a cursive representation of a name.

Flammable and non- flammable water polluting liquids storage tanks
On Site Report and Risk Analysis Matrix

Report Reference Number: Wasteserv Malta SAWTP

15. Additional Tank Details if Applicable: NOT APPLICABLE

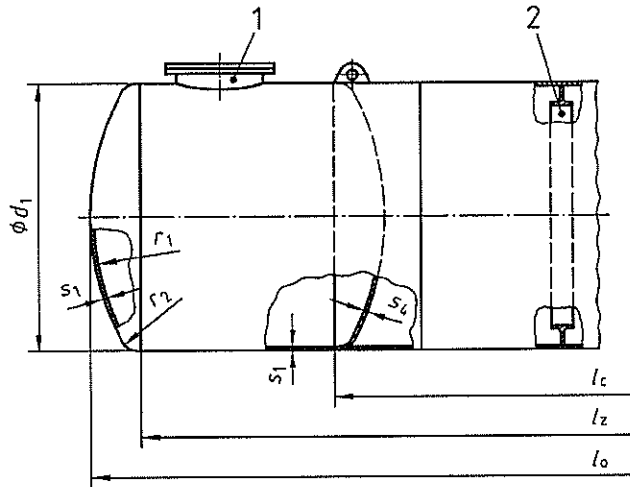

Tank type S

(single skin)

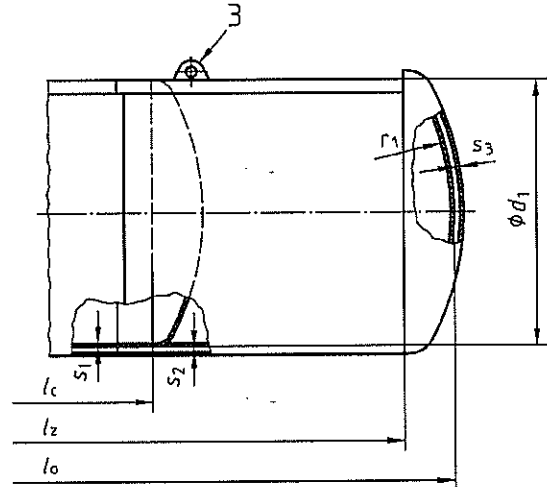

Tank type D

(double skin)

15.1. Overall dimensions:

a	l _o Overall length of tank	N.A
b	d ₁ Diameter of tank	
c	s ₁ Nominal thickness of inner skin	
d	s ₃ Nominal thickness of outer skin	
e	s ₅ Nominal thickness of compartment ends	

15.2. Manhole dimensions:

a	d ₂ Inside diameter of manhole	
b	d ₃ Diameter of cover	
c	s ₆ Flange thickness	
d	s ₇ Plate thickness of manhole body	
e	Number of bolts and size	

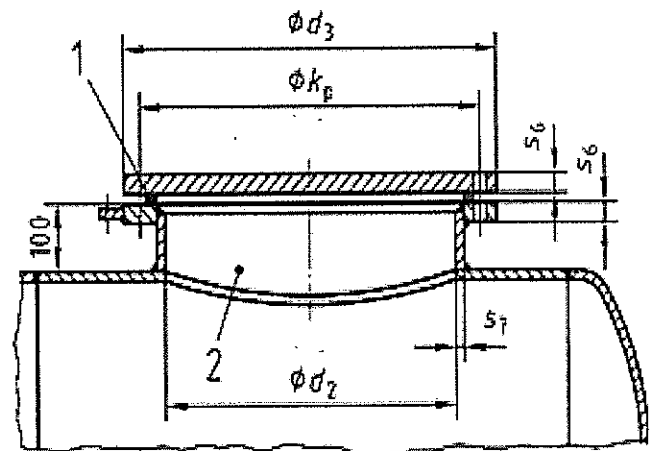
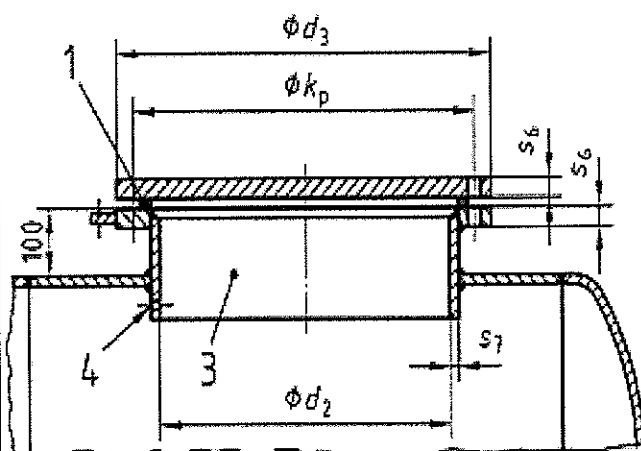

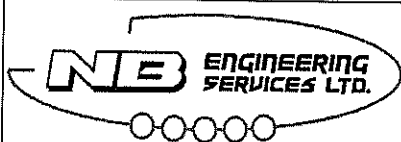

Petroleum for the Inland (Retail) Fuel Market
LN 53/2010
&
SL 545.22

Flammable and non- flammable water polluting liquids storage tanks
On Site Report and Risk Analysis Matrix

Report Reference Number: Wasteserv Malta SAWTP

15.3 Stiffening rings and lugs

s5 Nominal wall thickness of compartment dished ends	N.A
lc Compartment length	
Number of rings	
Apertures in rings visible	

15.4. External coating

Coating material – coating applied by factory supplier
Coating thickness - paint

15.5. Saddles and supports

a	s1 Thickness of compensation plate	N.A	e	e1 Saddle centre dist from circumferential weld	
b	b1 Saddle width		f	Loose or fixed saddles	
c	b2 Compensation plate width		g	Alpha angle of saddle	
d	k1 Saddle base plate		h	Beta angle of Compensation plate	

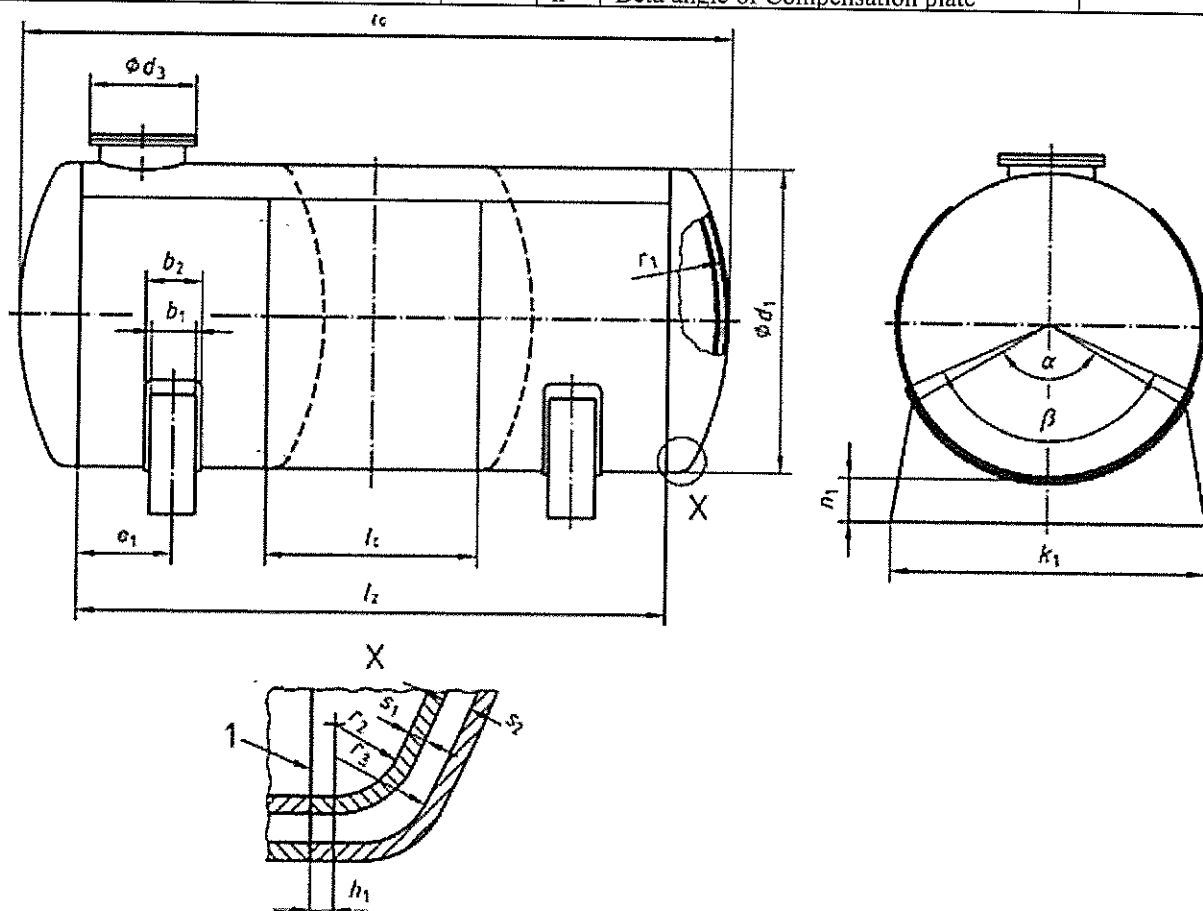

Handwritten signature

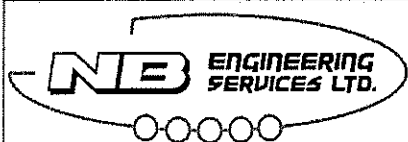

Petroleum for the Inland (Retail) Fuel Market

LN 53/2010

&

SL 545.22

Flammable and non- flammable water polluting liquids storage tanks
On Site Report and Risk Analysis Matrix

Report Reference Number: Wasteserv Malta SAWTP

16.0 Electrical Installation (If Applicable) - Details

Not applicable

17.0 Ancilliary equipment - Details

All equipment supplied according to Standard

18.0 Pumps – Details

Dispensing pump installed within the bunding system.

19.0 Overfill Protection

(a) Alarms and protection devices: Installed.

(b) Contents gauges: Visual liquid level.

(c) Stock control: Yes, maintained

20.0 Spill Containment Measures

Spill kits to be kept near tank. Available on site

21.0 Fire Precautions and considerations

(a) Preventing measures : Area well maintained, clean and no leakages.

(b) Fire fighting Equipment : Fire extinguishers and sand in the vicinity in the plant room. Available on site

(c) Detection equipment : Installed according to EN 13160

22.0 Emergency Procedures

(a) Fire: Prepared by Management and in effect.

(b) Spillage: Prepared by Management and in effect.

23.0 Personnel Training Details (If Applicable) – Details

Owner confirms that fire fighting training is programmed for a number of select employees.

24.0 Declaration by Competent Person

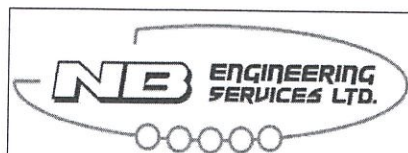

Petroleum for the Inland (Retail) Fuel Market

LN 53/2010

&

SL 545.22

**Flammable and non- flammable water polluting liquids storage tanks
On Site Report and Risk Analysis Matrix**

Report Reference Number: Wasteserv Malta SAWTP

I, the undersigned competent person, hereby declare that I have exercised reasonable skill and care when carrying out this risk assessment and that this report is a true and correct version of the installation status. I further declare that in my judgement, this installation is overall safe to be used as intended and that I have explained the contents and results of this report to the authorized person.

11/02/2019



Signature and Date:

25.0 Declaration by Applicant

I, the undersigned, declare that the installation described above has been installed and operational after January, 2016 and that I have understood all the contents of this Risk Assessment, after such contents having been explained to me by the competent person. I agree to implement the corrective actions listed in the report by not later than the target dates specified. Furthermore, I declare that I will submit another follow up report, endorsed by the Competent Person, to the Malta Resources Authority to verify successful implementation of the corrective actions. I also understand and accept that in the case of failure to submit on time a follow-up report and to submit the necessary proof of the corrective actions implementation thereof, I shall be making myself liable for any necessary action by the Malta Resources Authority including the suspension of my authorization and the imposition of administrative fines. I understand and agree that the Authority may require further inspections to be made when so required.

Signature and Date

20.0 Date of Next Inspection

January, 2020